

SurfaceWorks®

Specification Sheet

Type: Rapport Training

Table tops: Standard table tops are constructed with 1-1/8" M3 Industrial Grade 47# density particle board.

They are constructed with HPL (high pressure laminate) on the top side and a balanced backer on the bottom side for the greatest resistance to deflection. See the edge treatment guide for more information on table edging.

Base Construction: Bolted/ Welded

Base: Column- 2x2" 11-gauge steel tube stock

Plate- Welded 7-gauge steel with a 11-gauge steel gusset for increased stability

Options: Caster- 2" (50mm) diameter Hooded Twin Wheel Caster with brake

Glide- 5/16-18 x 1/2" zinc stem w/ 1-7/8" Blk base Glide

Ultra Flip Mechanism

Base Height: 27-3/4"

Base Spread: 16"

22"

26"



SurfaceWorks®

Assembly Instructions - Rapport Training

Parts list-

Top (Ultra-Flip Mechanism optional)

(2) Rapport Training Basic legs

(4) 5/16-18 flat head bolts (Ultra-Flip Only)

Training FIXED leg Assembly

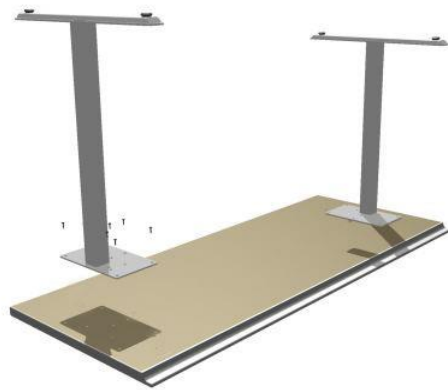

Step 1- Align mounting holes of fixed legs with pre-drilled pattern of Top

Step 2- Tighten mounting screws to secure top



FIXED LEG ASSEMBLY PROCESS COMPLETE
CONTINUE FOR ULTRA-FLIP ASSEMBLY
INSTRUCTIONS

SurfaceWorks®

Training Ultra Flip-Top Mechanism Assembly

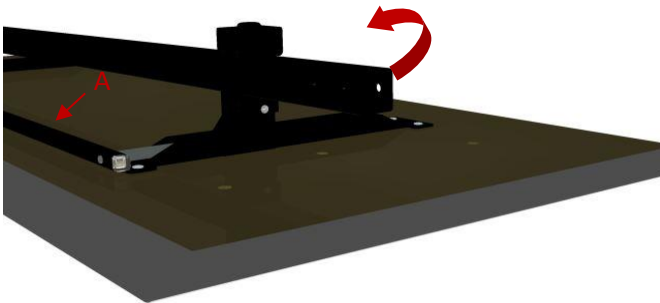

Step 1- Pull flip mechanism (A)
Rotate Ultra-Flip assembly to upright position

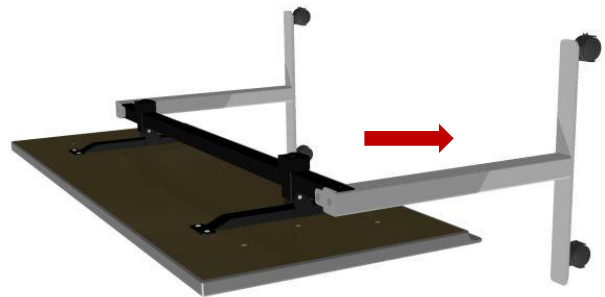

Step 2- For proper orientation feet and flip mechanism should be on same side
Note: Lock casters if applicable

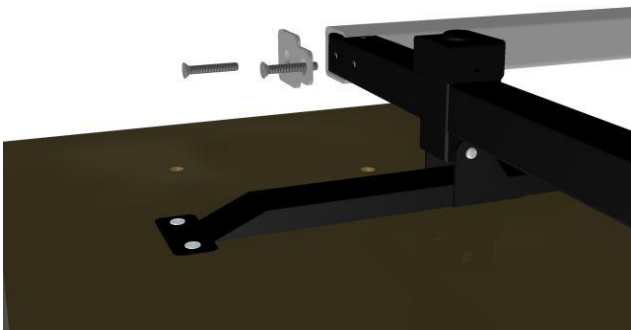

Step 3- Align holes in legs with beam and top caps
Tighten (4) 5/16-18 flat head bolts to secure base.



Set table with feet on the floor to complete process